



## Technical specifications and instructions



### **25 Frame Plunger pump**

**Standard brass model**

**2510**

**Stainless steel model**

**2511**

### Specifications (\*)

	<b>Model 2510</b>	<b>Model 2511</b>
<b>Flow</b>	76 L/min	76 L/min
<b>Pressure range</b>	6,9 to 138 bar	6,9 to 103 bar
<b>RPM</b>	1450 RPM	1450 RPM
<b>Inlet pressure range</b>	Flooded to 4,9 bar	Flooded to 4,9 bar
<b>Stroke</b>	38,5 mm	38,5 mm

### Common specifications

<b>Bore</b>	25 mm
<b>Crankcase capacity</b>	2,5 L
<b>Maximum liquid temperature</b>	60° C
<b>Inlet ports (2)</b>	1"-1/4" NPTF
<b>Discharge ports (2)</b>	3/4" NPTF
<b>Shaft diameter</b>	30 mm
<b>Weight (2510)</b>	36 kg
<b>Weight (2511)</b>	34 kg
<b>Dimensions</b>	512 x 382 x 220 mm

(\*) Abnormalities permitted only after consultation and written confirmation from Cat Pumps.

# Exploded View

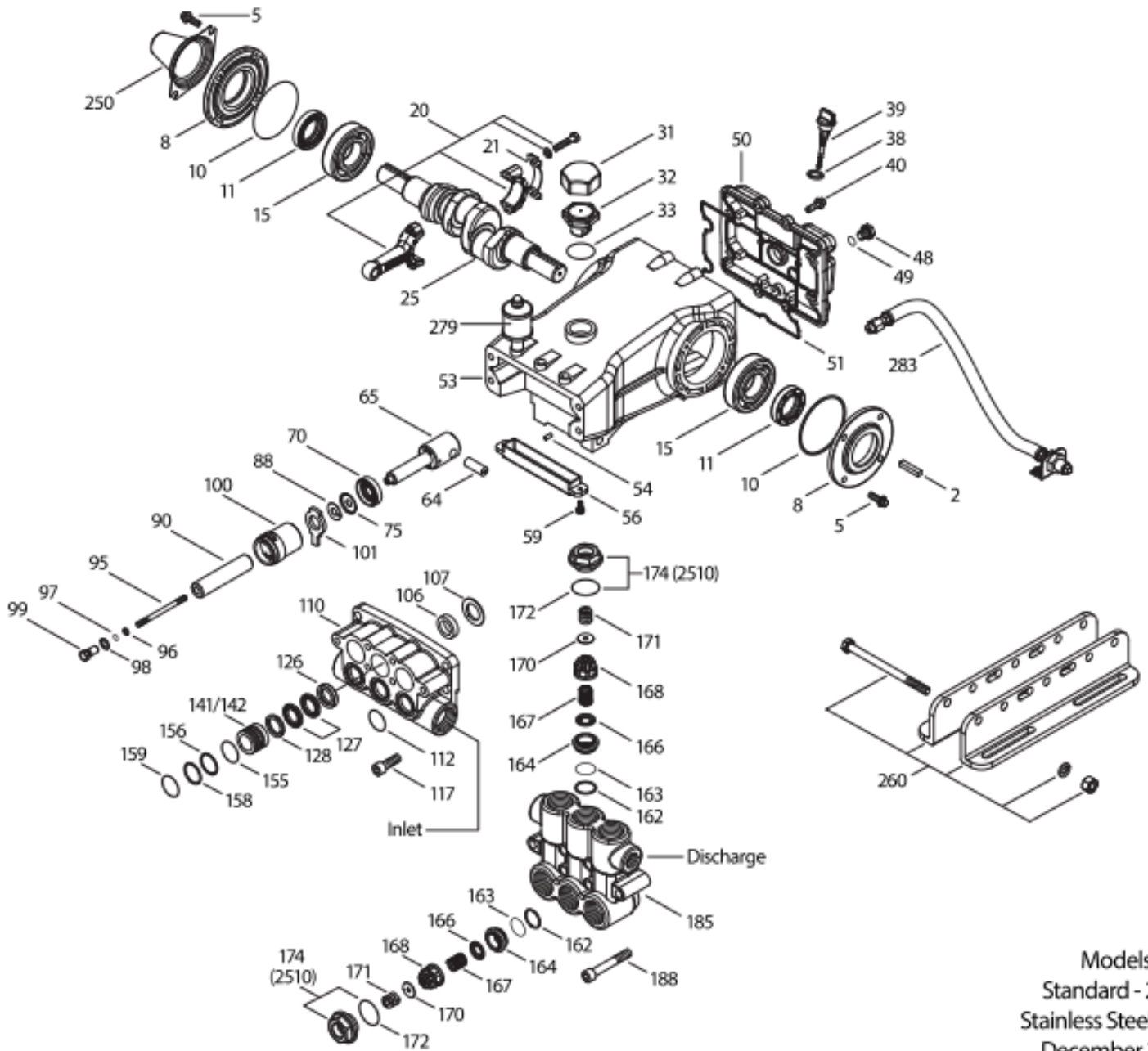

Models  
Standard - 2510  
Stainless Steel - 2511  
December 2016

# Parts list

Item	Num. 2510	Mat.	Num. 2511	Mat.	Description	Qty
2	990036	STL	990036	STL	Key (M8x7x40)	1
5	<b>126544</b>	<b>STCP R</b>	<b>125753</b>	<b>S</b>	Screw, sems HHC (M8x25)	8
8	27773	AL	27773	AL	Cover, bearing (see TB 118)	2
10	27772	NBR	27772	NBR	O-ring, bearing cover – 70D	2
11	27771	NBR	27771	NBR	Seal, oil, crankshaft – 70D	2
15	26512	STL R	26512	STL R	Bearing, ball	2
20	48613	TNM	48613	TNM	Rod, Connecting assembly (incl. lockwasher, washer, screw)	3
21	126562	STCP R	126562	STCP R	Washer, locking	3
25	49795	FCM	49759	FCM	Crankshaft, dual end	1
31	828710	PE	828710	PE	Protector, oil cap w/foam gasket	1
32	43211	ABS	43211	ABS	Cap, oil filler	1
33	14177	NBR	14177	NBR	O-ring, oil filler cap – 70D	1
38	129343	RBR	129343	RBR	Gasket, flat	1
39	27769	ABS	27769	ABS	Dip stick	1
40	<b>126544</b>	<b>STCP R</b>	<b>125753</b>	<b>S</b>	Screw, sems HHC (M8x25)	8
48	25625	STCP	25625	STCP	Plug, drain (1/4" x 19 BSP)	1
49	23170	NBR	23170	NBR	O-ring, drain plug – 70D	1
50	27768	AL	27768	AL	Cover, rear (see TB 118)	1
51	27767	NBR	27767	NBR	O-ring, rear cover – 70D	1
53	27762	AL	27762	AL	Crankcase with guide pins (see TB 118)	1
54	27488	S	27488	S	Pin, guide	2
56	27790	POP	27790	POP	Pan, oil	1
59	<b>125824</b>	<b>STCP R</b>	<b>92538</b>	<b>S</b>	Screw, sems HHC (M6x16)	2
64	27784	CM	27784	CM	Pin, crosshead	3
65	48719	SSHS	48719	SSHS	Rod, plunger	3
70	27785	NBR	27785	NBR	Seal, crankcase oil – 70D	3
75	110669	S	110669	S	Slinger, barrier	3
88	110670	S	110670	S	Washer, keyhole	3
90	48535	CC	48535	CC	Plunger, ceramic (M25x110)	3
95	<b>126549</b>	<b>STCP R</b>	<b>48679</b>	<b>SS</b>	Stud, plunger retainer (M7x103)	3
96	20184	PTFE	20184	PTFE	Back-up-ring, plunger retainer	3
97	14190	NBR	14190	NBR	O-ring, plunger retainer – 70D	3
	14161	FPM	14161	FPM	O-ring, plunger retainer – 70D	3
	# 48239	EPDM	# 48239	EPDM	O-ring, plunger retainer – 70D	3
98	44069	SS	44069	SS	Gasket, plunger retainer	3
99	44068	SS	44068	SS	Retainer, plunger (M7)	3
100	49788	NY	49788	NY	Retainer, LPS, front (03/11)	3
	49789	NY	49789	NY	Retainer, LPS, rear (03/11)	3
101	48487	-	48487	-	Wick, long tab	3
106	44086	NBR	44086	NBR	Seal, LPS w/SS-Spg	3
	45846	FPM	45846	FPM	Seal, LPS w/SS-Spg	3
	76086	ST2	76086	ST2	Seal, LPS w/S-Spg	3
	# 49196	EPDM	# 49196	EPDM	Seal, LPS w/SS-Spg	3
107	<b>48537</b>	<b>BB</b>	<b>48668</b>	<b>SS</b>	Washer, LPS	3
110	<b>48536</b>	<b>BBCP</b>	<b>48667</b>	<b>SS</b>	Manifold, inlet	1
112	11379	NBR	11379	NBR	O-ring, inlet manifold – 70D	3
	14183	FPM	14183	FPM	O-ring, inlet manifold	3
	# 701491	EPDM	# 701491	EPDM	O-ring, inlet manifold – 70D	3
117	<b>126510</b>	<b>STCP R</b>	<b>88398</b>	<b>S</b>	Screw, HSH (M12x35 and M12x40)	4
126	<b>48538</b>	<b>BB</b>	<b>48669</b>	<b>D</b>	Adapter, female	3
	-	-	<b>76667</b>	<b>SS</b>	Adapter, female	3
127	44610	STG	44610	STG	V-packing	6
128	<b>48539</b>	<b>BB</b>	<b>113025</b>	<b>SS</b>	Adapter, male	3
141	48672	SS	48672	SS	Spring, coil {12/02}	18

142	<b>48550</b>	<b>BB</b>	<b>48670</b>	<b>SS</b>	Spacer w/coil springs	3
155	17629	NBR	17629	NBR	O-ring, spacer-rear – 80D	3
	14183	<i>FPM</i>	14183	<i>FPM</i>	<i>O-ring, spacer-rear</i>	3
	# 701491	<i>EPDM</i>	# 701491	<i>EPDM</i>	<i>O-ring, spacer-rear – 70D</i>	3
156	28243	PTFE	28243	PTFE	Back-up-ring, spacer-rear	3
158	28243	PTFE	28243	PTFE	Back-up-ring, spacer-front	3
159	17629	NBR	17629	NBR	O-ring, spacer-front – 80D	3
	14183	<i>FPM</i>	14183	<i>FPM</i>	<i>O-ring, spacer-front</i>	3
	# 701491	<i>EPDM</i>	# 701491	<i>EPDM</i>	<i>O-ring, spacer-front – 70D</i>	3
162	48363	D	48363	D	Back-up-ring, seat	6
163	26142	NBR	26142	NBR	O-ring, seat – 80D	6
	14330	<i>FPM</i>	14330	<i>FPM</i>	<i>O-ring, seat – 70D</i>	6
	# 701493	<i>EPDM</i>	# 701493	<i>EPDM</i>	<i>O-ring, seat</i>	6
164	<b>48544</b>	<b>S</b>	<b>48676</b>	<b>SS</b>	Seat	6
166	45839	SS	45839	SS	Valve	6
167	45840	SS	45840	SS	Spring	6
168	110682	PVDF	110682	PVDF	Retainer, spring	6
170	44794	SS	44794	SS	Washer, spring retainer	6
171	48689	SS	48689	SS	Spring, coil {12/02}	6
172	17667	NBR	17667	NBR	O-ring, valve plug – 80D	6
	11745	<i>FPM</i>	11745	<i>FPM</i>	<i>O-ring, valve plug – 70D</i>	6
	# 48240	<i>EPDM</i>	# 48240	<i>EPDM</i>	<i>O-ring, valve plug</i>	6
174	<b>120693</b>	<b>BBCP</b>	<b>49295</b>	<b>SS</b>	Plug, valve (w/o-ring model 2510 only)	6
185	<b>48543</b>	<b>BBCP</b>	<b>48674</b>	<b>SS</b>	Manifold, discharge	1
188	<b>126511</b>	<b>STCP R</b>	<b>88399</b>	<b>S</b>	Screw, HSH (M12x80)	6
250	26516	<i>STCP</i>	26516	<i>STCP</i>	<i>Protector, shaft</i>	1
260	30614	<i>STZP R</i>	30614	<i>STZP R</i>	<i>Mount, rail, assy</i>	1
270	30059	<i>STL</i>	30059	<i>STL</i>	<i>Hub “H” (M30) (see TB 003)</i>	1
279	30278	<i>STZP</i>	30278	<i>STZP</i>	<i>Oilers (1 oz.)</i>	3
283	34334	-	34334	-	<i>Kit, oil drain (3/8”x24”)</i>	1
299	<b>816747</b>	<b>BBCP</b>	<b>816785</b>	<b>SS</b>	<i>Head, complete</i>	1
300	<b>31280</b>	<b>NBR*</b>	-	-	<i>Kit, seal (incl. 97,106,112,127,155,156,158,159) <b>standard</b></i>	1
	-	-	<b>76180</b>	<b>NBR*</b>	<i>Kit, seal w/FA (incl. 97,106,112,126,127,155,156,157,159) <b>st.</b></i>	1
	31380	<i>FPM*</i>	31380	<i>FPM*</i>	<i>Kit, seal (incl. 97,106,112,127,155,156,158,159)</i>	1
	76376	<i>STHT</i>	76376	<i>STHT</i>	<i>Kit, seal (incl. 97,106,112,127,155,156,158,159)</i>	1
	76291	<i>STHT</i>	76291	<i>STHT</i>	<i>Kit, seal (incl. 97,106,112,127,155,156,158,159)</i>	1
	# 76200	<i>EPDM*</i>	# 76200	<i>EPDM*</i>	<i>Kit, seal w/FA (incl. 97,106,112,126,127,155,156,157,159)</i>	1
310	<b>31285</b>	<b>NBR</b>	<b>31270</b>	<b>NBR</b>	<i>Kit, valve (incl. 162,163,164,166,167,168,170,172) <b>standard</b></i>	2
	<b>31385</b>	<b>FPM</b>	<b>31275</b>	<b>FPM</b>	<i>Kit, valve (incl. 162,163,164,166,167,168,170,172)</i>	2
	<b># 76197</b>	<b>EPDM*</b>	<b># 76370</b>	<b>EPDM*</b>	<i>Kit, valve (incl. 162,163,164,166,167,168,170,172)</i>	2

**Bold print part numbers are unique to a particular pump model. Italics are optional items.**

{ } Date of latest production change. R Components comply with RoHS directive. \* Review material codes for individual items (STG generally may be used as alternate).

See 'Tech Bulletins' 003, 024, 035, 036, 043, 074, 083, 085, 095 and 118 for additional information.

Material codes: (not part or part number)

ABS	ABS plastic	FPM	Fluorocarbon	SSHS	316SS / high strength
AL	Aluminium	NBR	Medium nitrile (Buna-N)	STCP	Steel / chrome plated
BB	Brass	NY	Nylon	STG	Special blend PTFE white
BBCP	Brass / chrome plated	PE	Polyethylene	STHT	Special PTFE high temp
CC	Ceramic	POP	Polypropylene	STL	Steel
CM	Chrome-moly	PTFE	Pure polytetrafluoroethylene	ST2	Special PTFE 2
D	Acetal	PVDF	Polyvinylidene fluoride	STZP	Steel / zinc plated
F	Cast iron	S	304SS	TNM	Special high strength
FCM	Forged chrome-moly	SS	316SS		