

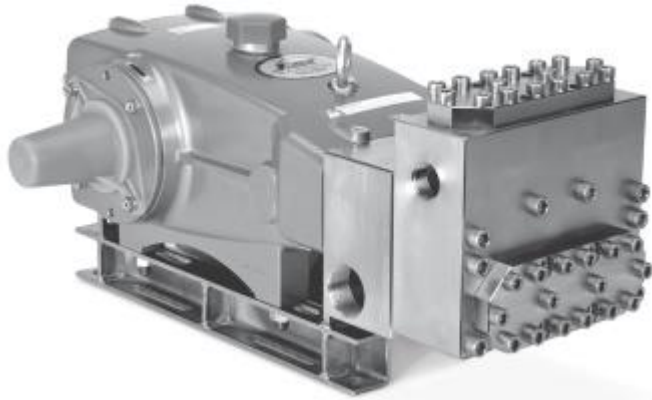

Technical specifications and instructions



38 Frame Block-Style Stainless Steel Plunger pump

Standard model 3841

Flushed model 3841K

Specifications (*)

Model 3841-3841K

Flow	174 l/min
Pressure range	7 to 70 bar
RPM	800 RPM

Common specifications

Inlet pressure range	Flooded to 4,9 bar
Bore	45 mm
Stroke	48 mm
Crankcase capacity	4 L
Maximum liquid temperature	60° C
Inlet ports (2)	1-1/2" NPTF
Flushing ports (2)	1/2" NPTF
Discharge ports (2)	1" NPTF
Shaft diameter	35 mm
Weight	63 kg
Dimensions	620 x 460 x 238 mm

(*) Abnormalities permitted only after consultation and written confirmation from Cat Pumps.

Exploded View

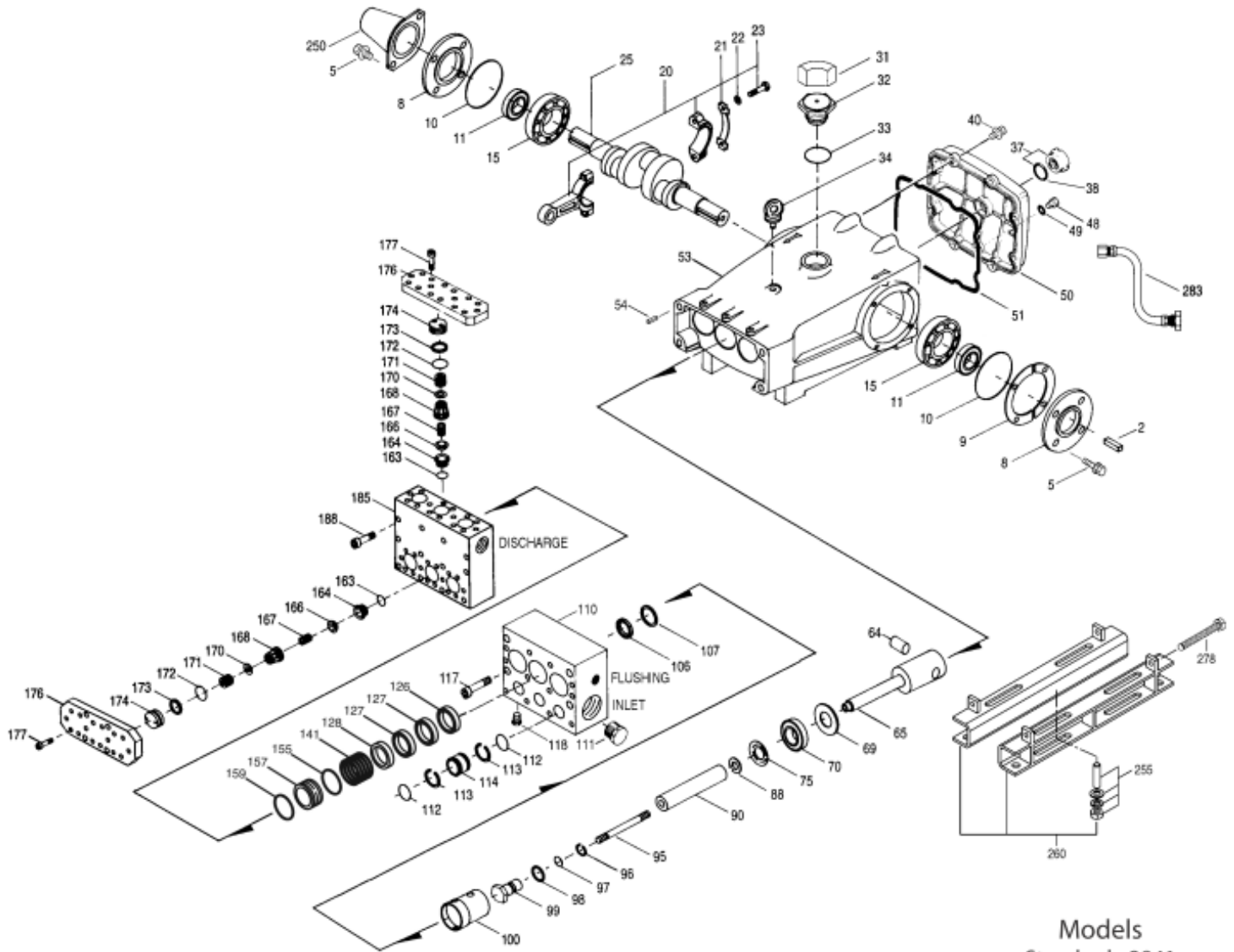

Models
Standard - 3841
Flushed - 3841K

Parts list

Item	Num. 3841	Mat.	Num. 3841K	Mat.	Description	Qty
2	34021	STL	34021	STL	Key (M10x8x70)	1
5	125753	S	125753	S	Screw, HH sems (M8x25)	8
8	44542	AL	44542	AL	Cover, bearing	2
9	815279	FBR	815279	FBR	Shim, split 2-pc	0-2
10	12398	NBR	12398	NBR	O-ring, bearing cover – 70D	2
11	13296	NBR	13296	NBR	Seal, oil, crankshaft	2
15	29326	STL	29326	STL	Bearing, roller	2
20	121467	TNM	121467	TNM	Rod, connecting assy (incl 21,22,23) {10/00}	3
21	126749	STCP R	126749	STCP R	Washer, locking (M10)	3
22	126593	STCP R	126593	STCP R	Washer, flat (M10)	6
23	122045	STZP	122045	STZP	Screw, HH (M10x55)	6
25	29325	FCM	29325	FCM	Crankshaft, dual end (M48)	1
31	828710	PE	828710	PE	Protector, oil cap w/foam gasket	1
32	43211	ABS	43211	ABS	Cap, oil filler	1
33	14177	NBR	14177	NBR	O-ring, oil filler cap – 70D	1
34	126743	STCP R	126743	STCP R	Bolt, eye (M12x1,75) (for lifting pump only)	1
37	92241	-	92241	-	Gauge, oil, bubble w/gasket – 80D	1
38	44428	NBR	44428	NBR	Gasket, flat – 80D	1
40	125753	S	125753	S	Screw, HH sems (M8 x 25)	8
48	25625	STCP	25625	STCP	Plug, drain (1/4" x 19 BSP)	1
49	23170	NBR	23170	NBR	O-ring, drain plug – 70D	1
50	45936	AL	45936	AL	Cover, rear	1
51	16612	NBR	16612	NBR	O-ring, cover – 70D	1
53	44487	AL	44487	AL	Crankcase assy (incl 34,54)	1
55	27488	S	27488	S	Pin, guide	2
64	43864	CM	43864	CM	Pin, crosshead	3
65	45116	STCP	45116	STCP	Rod, plunger	3
69	126587	STZP	126587	STZP	Washer, oil seal	3
70	100488	NBRS	100488	NBRS	Seal, oil, crankcase	3
	44739	FPM	44739	FPM	Seal, oil, crankcase	3
75	43865	S	43865	S	Slinger, barrier	3
88	45676	S	45676	S	Washer, keyhole (M16)	3
90	46806	CC	46806	CC	Plunger (M45x145)	3
95	89778	SS	89778	SS	Stud, plunger retainer (M10x135)	3
96	20189	PTFE	20189	PTFE	Back-up-ring, plunger retainer	3
97	11345	NBR	11345	NBR	O-ring, plunger retainer – 70D	3
	11375	FPM	11375	FPM	O-ring, plunger retainer	3
	# 701490	EPDM	# 701490	EPDM	O-ring, plunger retainer	3
98	44085	SS	44085	SS	Gasket, plunger retainer	3
99	44084	SS	44084	SS	Retainer, plunger (M10)	3
100	44119	PPG	44119	PPG	Retainer, seal	3
106	48384	NBR	48384	NBR	Seal, LPS w/SS-Spg	3
	702013	SFTB	702013	SFTB	Seal, LPS w/SS-Spg	3
	# 46945	EPDM	# 46945	EPDM	Seal, LPS w/S-Spg	3
107	48380	D	48380	D	Spacer, LPS	3
110	701865	SS	-	-	Manifold, inlet, block-style	1
	-	-	701982	SS	Manifold, inlet, block-style, flushed (1/2" NPTF flush)	1
111	701116	SS	701116	SS	Plug, inlet (1-1/2" NPT)	1
112	701632	NBR	701632	NBR	O-ring, inlet spacer	6
	701328	FPM	701328	FPM	O-ring, inlet spacer	6
	# 701973	EPDM	# 701973	EPDM	O-ring, inlet spacer	6
113	701329	PTFE	701329	PTFE	Back-up-ring, inlet spacer	6
114	701327	SS	701327	SS	Spacer, inlet	3
117	701252	SS	701252	SS	Screw HSH (M14x100)	4
118	701077	SS	-	-	Plug (1/4" NPT)	3
126	48383	D	48383	D	Adapter, female	3
127	46813	STGS	46813	STGS	V-packing	6
	703080	SFTB	703080	SFTB	V-packing	6
128	48386	SS	48386	SS	Adapter, male	3
141	49483	SS	45113	SS	Spring, coil, large (see TB 107)	3

155	17784	NBR	17784	NBR	O-ring, spacer – 80D	3
	20138	FPM	20138	FPM	O-ring, spacer – 80D	3
	# 701658	EPDM	# 701658	EPDM	O-ring, spacer – 80D	3
157	49506	SS	49506	SS	Spacer, V-packing (see TB 107)	3
159	17784	NBR	17784	NBR	O-ring, spacer – 80D	3
	20138	FPM	20138	FPM	O-ring, spacer – 80D	3
	# 701658	EPDM	# 701658	EPDM	O-ring, spacer – 80D	3
163	26142	NBR	26142	NBR	O-ring, seat – 80D	6
	14331	FPM	14331	FPM	O-ring, seat – 70D	6
	# 701660	EPDM	# 701660	EPDM	O-ring, seat	6
164	48393	SS	48393	SS	Seat	6
166	44108	SS	44108	SS	Valve	6
167	44109	SS	44109	SS	Spring	6
168	44728	PVDF	44728	PVDF	Retainer, spring	6
170	44729	SS	44729	SS	Washer, spring retainer	6
171	44644	SS	44644	SS	Spring, coil (70 kg), valve plug	6
172	89827	NBR	89827	NBR	O-ring, valve plug – 90D	6
	11747	FPM	11747	FPM	O-ring, valve plug – 90D	6
	# 701494	EPDM	# 701494	EPDM	O-ring, valve plug – 70D	6
173	48364	D	48364	D	Back-up-ring, valve plug	6
174	701278	SS	701278	SS	Plug, valve	6
176	701316	SS	701316	SS	Cover, valve	2
177	87951	S	87951	S	Screw, HSH (M10x30)	32
185	701866	SS	701866	SS	Manifold, discharge, block-style	1
188	701279	S	701279	S	Screw HSH (M12x100)	12
196	701342	SS	701342	SS	Plug, discharge (1" NPT) not shown	1
250	44516	NY	44516	NY	Protector, shaft (w/2 screws, lockwashers, washers) (incl with pump)	1
255	34039	S	34039	S	Assy, direct mount	1
260	92674	STZP R	92674	STZP R	Mount, rail, assy (incl:34018)	1
275	990013	STL	990013	STL	Hub, "B" (35mm w/keyway) (see TB 003)	1
278	80540	ZP	80540	ZP	Screw, HH (M12x100) (rail adjusting screw)	1
283	34314	-	34314	-	Kit, oil drain (3/8"x 48")	1
299	901410	SS	-	-	Head, complete, block-style	1
	-	-	901411	SS	Head, complete, block-style, flushed	1
300	31934	NBR	31934	NBR	Kit, seal (incl. 97,106,112,113,127,155,159)	1
	31961	FPM	31961	FPM	Kit, seal (incl. 97,106,112,113,127,155,159)	1
	# 31923	EPDM	# 31923	EPDM	Kit, seal (incl. 97,106,112,113,127,155,159)	1
310	33835	NBR	33835	NBR	Kit, valve (incl. 163,164,166,167,168,170,172,173)	2
	31262	FPM	31262	FPM	Kit, valve (incl. 163,164,166,167,168,170,172,173)	2
	# 31264	EPDM	# 31264	EPDM	Kit, valve (incl. 163,164,166,167,168,170,172,173)	2
-	819000	F	819000	F	Assembly, crankcase, cast iron conversion	1
370	-	-	990663	-	Assembly, flushing, 19L, 115V, 1.1 Amp, 1/2"NPT	1
390	714500	SS	714500	SS	C.A.T. (Captive Acceleration Tube)	1
391	714506	SS	714506	SS	Adapter (2 per C.A.T.)	2
392	701828	SS	701828	SS	Elbow assy used with adapter assy 714506	1

Bold print part numbers are unique to a particular pump model. Italics are optional items. { } Date of latest production change.
silicone oil/grease required. R Components comply with RoHS directive. * Review individual parts in each kit for material identification.
See 'Tech Bulletins' 002, 003, 024, 035, 036, 041, 043, 053, 074, 077, 083, 095 and 105 for additional information.
C.A.T. highly recommended for pressurized inlet, R.O. and industrial applications.

Material codes: (not part or part number)

ABS	ABS plastic	FPM	Fluorocarbon	SFTB	Special blend PTFE black
AL	Aluminum	NBR	Medium nitrile (Buna-N)	SS	316SS
CC	Ceramic	NBRs	Buna, silicone free	SSZZ	316SS / zamak
CM	Chrome-moly	NY	Nylon	STCP	Steel/chrome plated
D	Acetal	PE	Polyethylene	STGS	Special blend PTFE white
EPDM	Ethylene propylene diene mon.	PPG	Glass filled polypropylene	STL	Steel
F	Cast iron	PTFE	Pure polytetrafluoroethylene	STZP	Steel / zinc plated
FBR	Fiber	PVDF	Polyvinylidene fluoride	TNM	Special high strength
FCM	Forged chrome-moly	S	304SS	ZP	Zinc plated