



## Technical specifications and instructions



### **68 Frame Block-Style Stainless Steel Plunger pump**

**Standard models**

**6841, 6861**

**Flushed models**

**6841K, 6861K**

### Specifications (\*)

	<b>Model 6841-6841K</b>	<b>Model 6861-6861K</b>
<b>Flow</b>	182,5 l/min	227 l/min
<b>Pressure range</b>	7 to 140 bar	7 to 85 bar
<b>RPM</b>	615 RPM	520 RPM
<b>Bore</b>	45 mm	55 mm

### Common specifications

<b>Inlet pressure range</b>	Flooded to 3,5 bar
<b>Stroke</b>	65,5 mm
<b>Crankcase capacity</b>	9,46 L
<b>Maximum liquid temperature</b>	60° C
<b>Inlet ports (2)</b>	2-1/2" NPTF
<b>Flushing ports (2)</b>	1/2" NPTF
<b>Discharge ports (2)</b>	1-1/4" NPTF
<b>Shaft diameter</b>	45 mm
<b>Weight</b>	206 kg
<b>Dimensions</b>	733 x 618 x 321 mm

(\*) Abnormalities permitted only after consultation and written confirmation from Cat Pumps.

# Exploded View

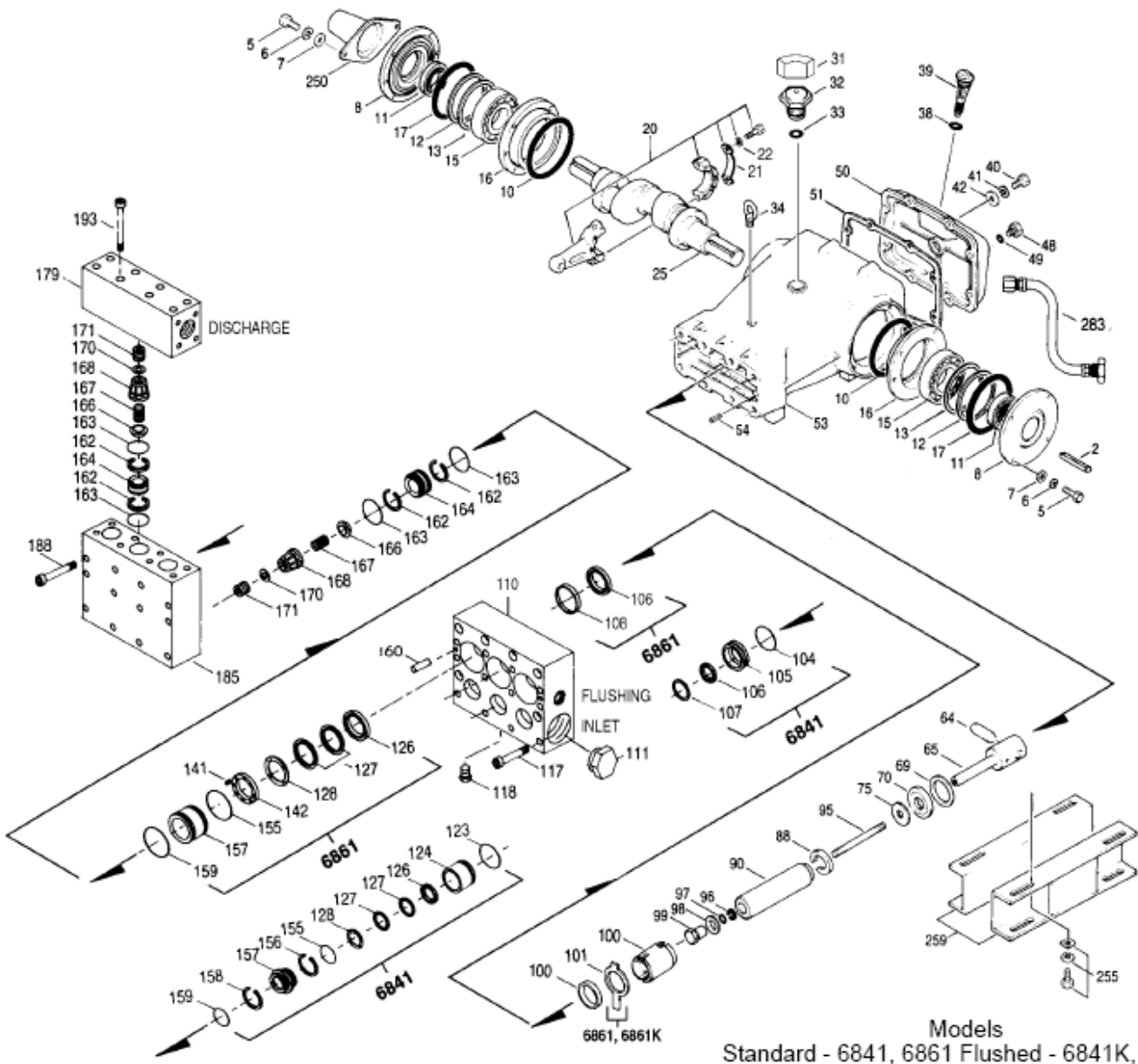

# Parts list

Item	Num. 6841 6841K	Mat.	Num. 6861 6861K	Mat.	Description	Qty
2	43048	STL	43048	STL	Key (M14x9x90)	1
5	89728	S	89728	S	Screw, HH (M10x40)	8
6	15847	S	15847	S	Lockwasher (M10)	8
7	19934	S	19934	S	Washer, flat (M10)	8
8	29443	AL	29443	AL	Cover, bearing – outer	2
10	29444	NBR	29444	NBR	O-ring, bearing cover – 70D	2
11	11443	NBR	11443	NBR	Seal, oil, crankshaft – 70D	2
12	43642	STZP	43642	STZP	Washer, shim (M120x0,3)	0-2
	126594	STCP R	126594	STCP R	Washer, shim (M120x0,3)	0-2
13	126595	STCP R	126595	STCP R	Washer, shim (M120x0,5)	0-2
15	29441	STL	29441	STL	Bearing, roller	2
16	29442	STL	29442	STL	Cover, bearing – inner	2
17	29444	NBR	29444	NBR	O-ring, bearing cover – 70D	2
20	126612	BBHS	126612	BBHS	Assembly, connecting rod (incls 21,22)	3
21	126560	STCP R	126560	STCP R	Washer, locking	3
22	126593	STCP R	126593	STCP R	Washer, shim (M10,5x1,5)	6
25	29440	FCM	29440	FCM	Crankshaft, dual end	1
31	828710	-	828710	-	Protector, oil cap w/foam gasket	1
32	43211	ABS	43211	ABS	Cap, oil filler	1
33	14177	NBR	14177	NBR	O-ring, filler cap – 70D	1
34	126743	STCP R	126743	STCP R	Bolt, eye (M12) (for lifting pump only)	1
38	11338	NBR	11338	NBR	O-ring, dipstick – 70D	1
39	27769	ABS	27769	ABS	Dipstick	1
40	89627	S	89627	S	Screw, HH (M10x30)	8
41	15847	S	15847	S	Lockwasher (M10)	8
42	19934	S	19934	S	Washer, flat (M10)	8
48	25625	STCP	25625	STCP	Plug, drain (1/4" x 19 BSP)	1
49	23170	NBR	23170	NBR	O-ring, drain plug – 70D	1
50	29438	AL	29438	AL	Cover, rear	1
51	29439	NBR	29439	NBR	Gasket, rear cover	1
53	45303	AL	45303	AL	Crankcase (incl 34,54)	1
54	43282	S	43282	S	Pin, guide	2
64	29481	CM	29481	CM	Pin, crosshead	3
65	45384	SSZZ	45384	SSZZ	Rod, plunger	3
69	126588	STCP R	126588	STCP R	Washer, oil seal	3
70	29454	NBR	29454	NBR	Seal, oil, crankcase – 80D	3
75	44752	NBR	44752	NBR	Slinger, barrier – 85D	3
88	45677	SS	45677	SS	Washer, keyhole (M14)	3
90	45672	CC	44749	CC	Plunger (M45x185)(M55x185)	3
95	44748	SS	44748	SS	Stud, plunger retainer (M14x147)	3
96	20214	PTFE	20214	PTFE	Back-up-ring, plunger retainer	3
97	17616	NBR	17616	NBR	O-ring, plunger retainer – 80D	3
	11686	FPM	11686	FPM	O-ring, plunger retainer – 80D	3
98	44751	SS	44751	SS	Gasket, plunger retainer	3
99	44750	SS	44750	SS	Plunger, retainer (M14)	3
100	855000	PVDF	855000	PVDF	Retainer, seal, 2-pc	3
101	-	-	44762	-	Wick, long tab	3
104	18178	NBR	-	-	O-ring, inlet adapter – 80D	3
	13338	FPM	-	-	O-ring, inlet adapter – 70D	3
105	701355	SS	-	-	Adapter, LPS	3
106	106147	NBR	44757	NBR	Seal, LPS w/SS-Spg	3
	701752	SFTA*	45882	FPM	Seal, LPS w/SS-Spg	3
107	701356	SS	-	-	Washer, LPS	3
108	-	-	46167	SS	Spacer, LPS	3
110	46166	SSL	16166	SSL	Manifold, inlet, block-style (6841-6861)	1
	701343	SSL	701343	SSL	Manifold, inlet, block-style, flushed (6841K-6861K)	1
111	701353	SS	701353	SS	Plug, inlet manifold (2-1/2" NPTM)	1
117	89694	S	89694	S	Screw HSH (M16x110)	6
118	701077	SS	701077	SS	Plug (1/4" NPT) (6841-6861)	3
123	18178	NBR	-	-	O-ring, V-packing cylinder – 80D	3

	<b>13338</b>	<b>FPM</b>	-	-	O-ring, V-packing cylinder – 70D	3
124	<b>701357</b>	<b>SSL</b>	-	-	Cylinder, V-packing	3
126	<b>701358</b>	<b>SS</b>	<b>701358</b>	<b>SS</b>	Adapter, female	3
	-	-	<b>48392</b>	<b>D</b>	<i>Adapter, female</i>	3
127	<b>104450</b>	<b>STG*</b>	<b>44764</b>	<b>STG*</b>	V-packing	6
128	<b>701359</b>	<b>SS</b>	<b>45772</b>	<b>SS</b>	Adapter, male	3
141	-	-	<b>44943</b>	<b>SS</b>	Spring, coil	18/24
142	-	-	<b>45383</b>	<b>SS</b>	Spacer w/coil springs	3
155	<b>701978</b>	<b>NBR</b>	<b>18178</b>	<b>NBR</b>	O-ring, V-packing spacer, inner	3
	<b>701360</b>	<b>FPM</b>	<b>13328</b>	<b>FPM</b>	<i>O-ring, V-packing spacer, inner</i>	3
156	<b>701361</b>	<b>PTFE</b>	-	-	Back-up-ring, spacer, inner	3
157	<b>701362</b>	<b>SS</b>	-	-	Spacer, V-packing w/coil springs	3
	-	-	<b>45321</b>	<b>SS</b>	<i>Spacer, V-packing</i>	3
158	<b>701363</b>	<b>PTFE</b>	-	-	Back-up-ring, spacer, outer	3
159	18178	NBR	18178	NBR	O-ring, V-packing spacer, outer – 80D	3
	13338	<i>FPM</i>	13338	<i>FPM</i>	<i>O-ring, spacer, outer – 70D</i>	3
160	44756	S	44756	S	Pin, guide	2
162	23116	PTFE	23116	PTFE	Back-up-ring, seat	12
163	12392	NBR	12392	NBR	O-ring, seat – 70D	12
	13279	<i>FPM</i>	13279	<i>FPM</i>	<i>O-ring, seat – 70D</i>	12
164	46173	SS	46173	SS	Seat	6
166	44774	SS	44774	SS	Valve	6
167	44773	SS	44773	SS	Spring	6
168	44775	PVDF	44775	PVDF	Retainer, spring	6
170	44776	SS	44776	SS	Washer, retainer	6
171	701354	SS	701354	SS	Spring, coil, retainer	6
179	46176	SSL	46176	SSL	Manifold, discharge, block-style	1
185	46171	SSL	46171	SSL	Manifold, valve, block-style	1
188	89694	S	89694	S	Screw, HSH (M16x110), lower	12
193	89694	S	89694	S	Screw, HSH (M16x110), upper	8
250	29445	AL	29445	AL	<i>Protector, shaft</i>	1
255	33243	STZP	33243	STZP	Kit, mount (included w/pump)	2
259	29477	STZP	29477	STZP	Rail, box (included w/pump)	2
275	990014	STL	990014	STL	<i>Hub, "B" M45 w/keyway M14x9x90 (see TB 003)</i>	1
283	34314	-	34314	-	<i>Kit, oil drain</i>	1
299	<b>910201</b>	<b>SSL</b>	<b>910200</b>	<b>SSL</b>	<i>Head, complete, block-style (6841-6861)</i>	1
	<b>910203</b>	<b>SSL</b>	<b>910202</b>	<b>SSL</b>	<i>Head, complete, block-style, flushed (6841K-6861K)</i>	1
300	-	-	<b>34106</b>	<b>NBR*</b>	<i>Kit, seal (incl. 97,106,127,155,159,163)</i>	1
	<b>34098</b>	<b>NBR*</b>	-	-	<i>Kit, seal (incl. 97,104,106,123,127,155,156,158,159,163)</i>	1
	-	-	<b>33406</b>	<b>FPM*</b>	<i>Kit, seal (incl. 97,106,127,155,159,163)</i>	1
	<b>701365</b>	<b>FPM*</b>	-	-	<i>Kit, seal (incl. 97,104,106,123,127,155,156,158,159,163)</i>	1
310	34105	NBR	34105	NBR	<i>Kit, valve (incl. 159,162,163,164,166,167,168,170)</i>	2
	701801	<i>FPM</i>	701801	<i>FPM</i>	<i>Kit, valve (incl. 159,162,163,164,166,167,168,170)</i>	2
370	<b>990663</b>	-	<b>990663</b>	-	<i>Assembly, flushing, 19L, 115V, 1.1 Amp, 1/2"NPT (6841K-6861K)</i>	1
-	717500	SS	717500	SS	<i>C.A.T. (Captive Acceleration Tube)</i>	1
-	717510	SS	717510	SS	<i>Adapter (2 per C.A.T.)</i>	2
-	819010	F	819010	F	<i>Assy, crankcase, cast iron conversion</i>	1

**Bold print part numbers are unique to a particular pump model. Italics are optional items.** R Complies with RoHS Directive.

\* Review material codes for individual items (STG and SFTA generally may used as alternate).

See 'Tech Bulletins' 003, 024, 036, 043, 074, 077, 083, 084, 095 and 105 for additional information.

**C.A.T. highly recommended for pressurized inlet, R.O. and industrial applications.**

Material codes: (not part or part number)

ABS	ABS plastic	FPM	Fluorocarbon	SSL	316SS / low carbon
AL	Aluminum	HS	High strength	SSZZ	316SS / zamak
BBHS	Brass / high strength	NBR	Medium nitrile (Buna-N)	STCP	Steel/chrome plated
CC	Ceramic	PTFE	Pure polytetrafluoroethylene	STG	Special blend PTFE white
CM	Chrome-moly	PVDF	Polyvinylidene fluoride	STL	Steel
D	Acetal	S	304 stainless steel	STZP	Steel / zinc plated
F	Cast iron	SFTA	Special blend PTFE tan		
FCM	Forged chrome-moly	SS	316 stainless steel		